

LEGEND:

- Sign Location
- Delineator
- Close One Burbocks
- Traffic Control Person
- Closure Area

VALLEY TRAFFIC SYSTEMS
 VALLEY TRAFFIC SYSTEMS, INC.
 TRAFFIC MANAGEMENT DIVISION
 8775 118A STREET
 LANSLEY BC V1M 3T7
 PHONE: 604-815-8219
 FAX: 604-815-3841

REVISIONS:

DATE	DETAILS

- NOTES:**
1. Dates: Mar 08, 2018
 2. Hours of Operation: TBD
 3. Duration: TBD
 4. Traffic Plan based on a 50 km/h speed zone
 5. TCPs to assist pedestrians and cyclists as required

MUNICIPAL PROJECT NO.
 MUNICIPAL CONTRACT:
 COUNTY CONTRACT:
 OUR STOPS TO BE REMOVED:
 PAVING METERS TO BE REMOVED:

RIGHT ON FLAGGERS

CITY OF CHILLIWACK: YALE RD BETWEEN NOWEL ST AND VICTOR ST

ENGINEER SEAL

Traffic Control Plan: SLAT Traffic onto Eastbound Lane

SCALE: NTS	DATE: 07.03.2018	VIS PROJ. NO.: 16444	DWG. NO.: DWG 01	REV. NO.: 00	REV. BY: TONY
------------	------------------	----------------------	------------------	--------------	---------------

© Valley Traffic Systems, a division of Valley Traffic

TS

BR

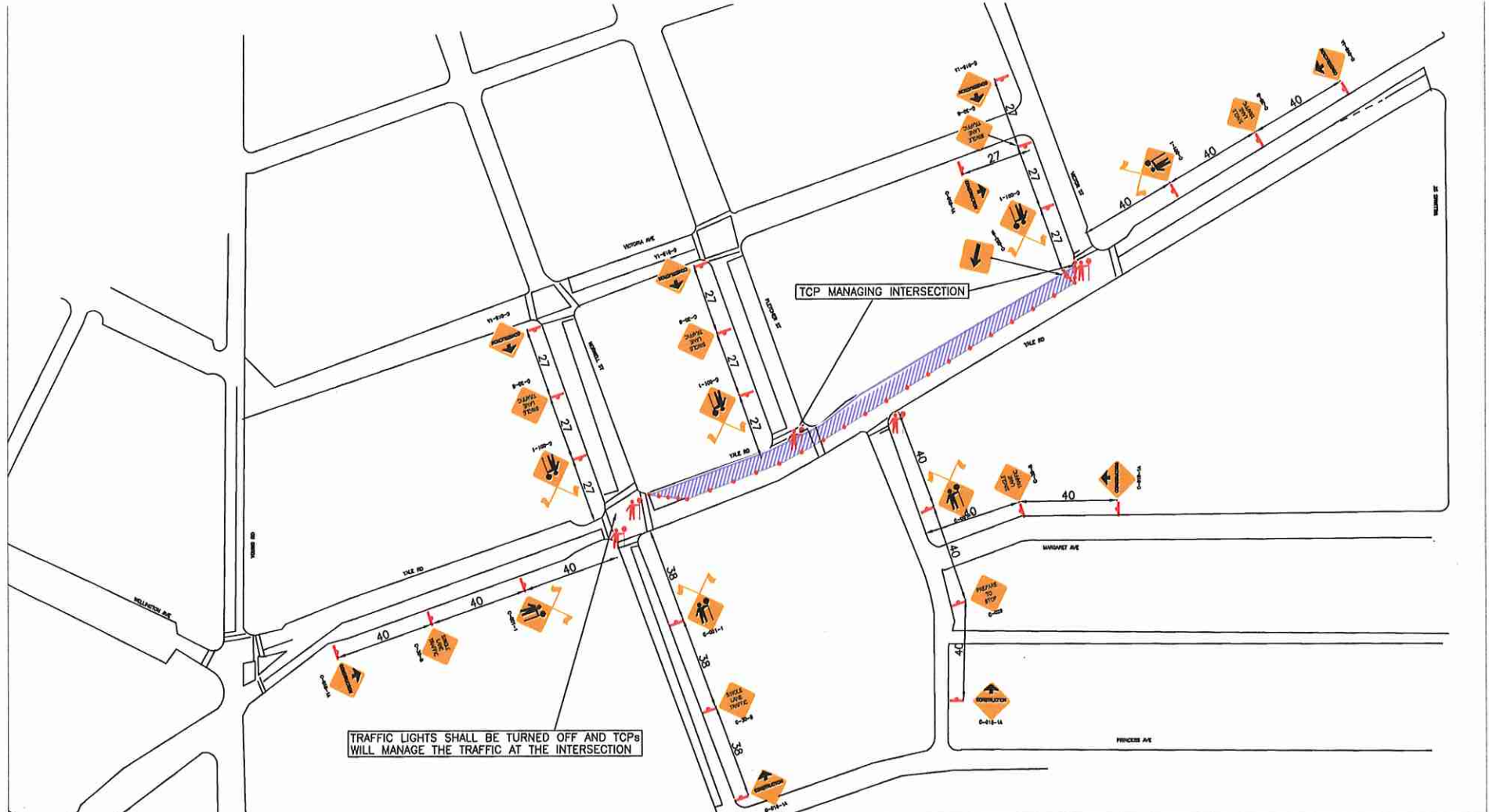

TRAFFIC LIGHTS SHALL BE TURNED OFF AND TCPs WILL MANAGE THE TRAFFIC AT THE INTERSECTION

LEGEND:

- Sign Location
- Delimitor
- Close One Baricade
- Traffic Control Person
- Closure Area

VALLEY TRAFFIC SYSTEMS
 VALLEY TRAFFIC SYSTEMS, INC.
 TRAFFIC MANAGEMENT DIVISION
 8720 156A STREET
 LANGLEY BC V1Y 5J7
 PHONE: 604-913-2519
 FAX: 604-913-2661

REVISIONS:

DATE	DETAILS

NOTES:

1. Dates: Mar 08, 2018
2. Hours of Operation: TBD
3. Duration: TBD
4. Traffic Plan based on a 50 km/h speed zone
5. TCPs to assist pedestrians and cyclists as required

MUNICIPAL PROJECT NO.
 MUNICIPAL CONTACT
 CREDIT CONTACT
 BUS STOP(S) TO BE REMOVED
 PARKING METERS TO BE REMOVED

RIGHT ON FLAGGERS

CITY OF CHILLIWACK: YALE RD BETWEEN NOWEL ST AND VICTOR ST

Traffic Control Plan: SLAT Traffic onto Westbound Lane

SCALE	DATE	VTS PROJ. NO.	DWG. NO.	REV. BY
NTS	07.03.2018	16444	DWG 02	00 TONY

© Valley Traffic Systems, Inc. All Rights Reserved. Project: 15004